

BATHHOUSE / SHOWER & FAMILY FACILITIES CONSTRUCTION NOTES:

- BATHHOUSE/SHOWER & FAMILY FACILITIES, CONCESSION & STORAGE AREA RENOVATION & NEW CONSTRUCTION TO CONSIST OF BUT NOT LIMITED TO THE FOLLOWING:
 - DEMOLITION PER REQUIREMENTS. SEE D-2.0, PD-1.1 & ED-1.1
 - PLUMBING & FIXTURES PER REQUIREMENTS.
 - ELECTRICAL & EQUIPMENT PER REQUIREMENTS.
 - CONSTRUCTION OF NEW CMU WALL (EXISTING ROOMS).
 - CONSTRUCTION OF NEW CEILING IN EXISTING SHOWERS
 - REPAIR & PREPARE EXISTING WALLS & FINISH PER ROOM FINISH SCHEDULE.
 - REPAIR/REPLACEMENT OF CONCRETE FLOORS AS REQUIRED & FINISH FLOOR PER ROOM FINISH SCHEDULE. SEE A-2.10 & A-4.0
 - CLEANING & PREPARATION OF CEILINGS & PAINT PER ROOM FINISH SCHEDULE.
 - PURCHASE AND INSTALL HDPE PARTITIONS & ACCESSORIES, WATER CLOSETS & URINALS, VANITIES & LAVATORIES, DRESSING & SHOWER COMPARTMENTS & ACCESSORIES. SEE SCHEDULES.
 - PURCHASE & INSTALL ALL ACCESSORIES PER ACCESSORIES SCHEDULE.
 - PURCHASE & INSTALL DOORS, FRAMES & HARDWARE PER DOOR SCHEDULE & FINISH PER ROOM FINISH SCHEDULE. REFURBISHED EXISTING DOORS.
 - PURCHASE & INSTALL LOCKERS AS SHOWN ON PLAN VIEW. SEE SCHEDULES.
 - CONSTRUCT ENCLOSED STORAGE AREAS IN DRESSING ROOMS. PROVIDE & INSTALL SHELVING. SEE SCHEDULES FOR SHELVING.
 - CONSTRUCT STORAGE AREAS FOR CONCESSIONS.
 - CONSTRUCT COUNTERS WITH STORAGE ABOVE & BELOW IN EXPANDED CONCESSION AREA.
 - PURCHASE & INSTALL BENCHES IN DRESSING AREAS.
 - CEILING AT ENTRANCE TO BE CLEANED, PREPPED, & PAINTED.
 - REPLACE ALL FASCIA, SOFFIT & TRIM AT OPEN AIR AREA IN WOMEN'S & MEN'S DRESSING AREA.
 - REPAIR/REPLACE ALL FASCIA, SOFFIT & TRIM ON EXTERIOR OF BUILDING AS SPECIFIED.
 - IF ALTERNATE BID #1 IS CHOSEN CONSTRUCT ROOF ENCLOSURE OVER OPEN AREAS IN WOMEN'S & MEN'S DRESSING AREA.
- CONTRACTOR TO REPAIR ALL FLOORS, WALLS & CEILINGS ASSOCIATED WITH THE DEMOLITION OF EXISTING WALLS, PLUMBING, ELECTRICAL, FIXTURES & EQUIPMENT.
- CONTRACTOR TO REPAIR ALL FLOORS, WALLS & CEILING ASSOCIATED WITH THE RENOVATION OF WALLS, PLUMBING, ELECTRICAL, FIXTURES & EQUIPMENT.
- CONTRACTOR TO REPAIR INTERIOR & EXTERIOR WALL CRACKS. INTERIOR WALLS - TO BE REPAIRED WITH A SURFACE BONDING CEMENT W/ADD MIXTURE TO ALLOW FLEXING. EXTERIOR WALLS - TO BE REPAIRED WITH MORTAR TO MATCH EXISTING COLOR, TEXTURE & TOOLING. AREAS TO BE REPAIRED TO BE CLEANED, PREPPED & PRODUCTS APPLIED PER THE MANUFACTURER'S INSTRUCTIONS.
- CONTRACTOR TO SUPPLY THE FOLLOWING CROWD CONTROL ITEMS:
 - EIGHT (8) ADJUSTABLE LENGTH CROWD CONTROL BARRIERS.
 - BARRIERS TO BE 40" HIGH ALUMINUM POSTS COLOR BLACK W/DUAL LINES COLOR BLACK W/WHITE STRIPE.
 - ONE (1) SIGN KIT - (PLEASE ENTER HERE).
 - ONE (1) POST DOLLY FOR CROWD CONTROL BARRIER POSTS.
- CONTRACTOR TO PROVIDE & INSTALL PREMIER 36 INCH 6-BURNER GAS RANGE - MODEL # P36S338BP - STAINLESS STEEL. INCLUDE RANGE HOOD & EXHAUST. SEE A-2.8 & H-1.1
- ALL MATERIALS & PRODUCTS TO BE APPLIED/INSTALLED PER MANUFACTURER'S PRODUCT SPECIFICATIONS & INSTALLATION INSTRUCTIONS.
- AREAS OF CONCRETE FLOOR BEING REPLACED TO BE 4" THICK 3500 PSI CONCRETE WITH 6x6 #10 W.W.F. SLOPED 1/8":12" TOWARD FLOOR DRAINS. HAND FLOATED, TROWELED & DOUBLE EDGED W/IGHT BROOM FINISH SUITABLE FOR BARE FEET. EXPOSED AGGREGATE WILL NOT BE ACCEPTABLE.
- A REQUEST FOR CHANGE OF CONSTRUCTION OR DEVIATION FROM PLAN SET, CONTRACTOR TO SUBMIT A DETAILED & SCALED DRAWING TO THE CONSULTANT FOR APPROVAL. CONSULTANT WILL MAKE ALL SUBMITTAL APPROVALS IN WRITING. SUBMITTALS REQUIRE A MIN. OF SEVEN (7) DAYS FOR REVIEW.

GENERAL NOTES:

- CONTRACTOR TO VISIT SITE PRIOR TO BID TO VERIFY REQUESTED WORK, SITE CONDITIONS & EQUIPMENT.
- CONTRACTOR TO REVIEW ALL DRAWING PAGES BEFORE COMMENCEMENT OF CONSTRUCTION.
- ALL DIMENSIONS & EXISTING EQUIPMENT SHOULD BE VERIFIED ON SITE BY CONTRACTOR. ANY DISCREPANCIES IN DIMENSIONS OR EXISTING EQUIPMENT ON DRAWINGS OR CLARITY OF NOTES OR CLARITY OF CONSTRUCTION PROCESS TO BE BROUGHT TO THE ATTENTION OF CONSULTANT.
- ALL BIDDERS REQUIRED TO SUBMIT BID PRICES FOR BASE BID AND ALTERNATE BIDS SHOWN ON DRAWING & AS DESCRIBED BY NOTES.
- ALL CONSTRUCTION TO BE COMPLETED IN COMPLIANCE WITH NSPI, NSF, ANSI, ACI AND ALL STATE & LOCAL CODES, AS WELL AS THE IEBC.
- ALL ACCESS AREAS AND ROUTES TO & FROM CONSTRUCTION AREA TO BE APPROVED BY CONSULTANT & OWNER PRIOR TO COMMENCEMENT OF CONSTRUCTION. ALL ACCESS AREAS AND ANY ADDITIONAL AREAS DISTURBED OR DAMAGED DURING CONSTRUCTION TO BE RESTORED/REPAIRED TO ORIGINAL CONDITION.
- CONTRACTOR TO SECURE SITE DURING ALL PHASES OF CONSTRUCTION.
- CONTRACTOR TO PROPERLY DISPOSE OF ALL MATERIALS OFF SITE DURING CONSTRUCTION.
- CONTRACTOR RESPONSIBLE FOR ALL APPLICABLE PERMITS & FEES.

ALTERNATE BID #1
ROOF ENCLOSURE OVER OPEN AREA IN WOMEN'S & MEN'S DRESSING AREAS. SEE A-2.2

ALTERNATE BID #2
ALTERNATE FLOOR FINISH IN CONCESSION & FOOD PREP AREAS. SEE A-2.10 & A-4.0

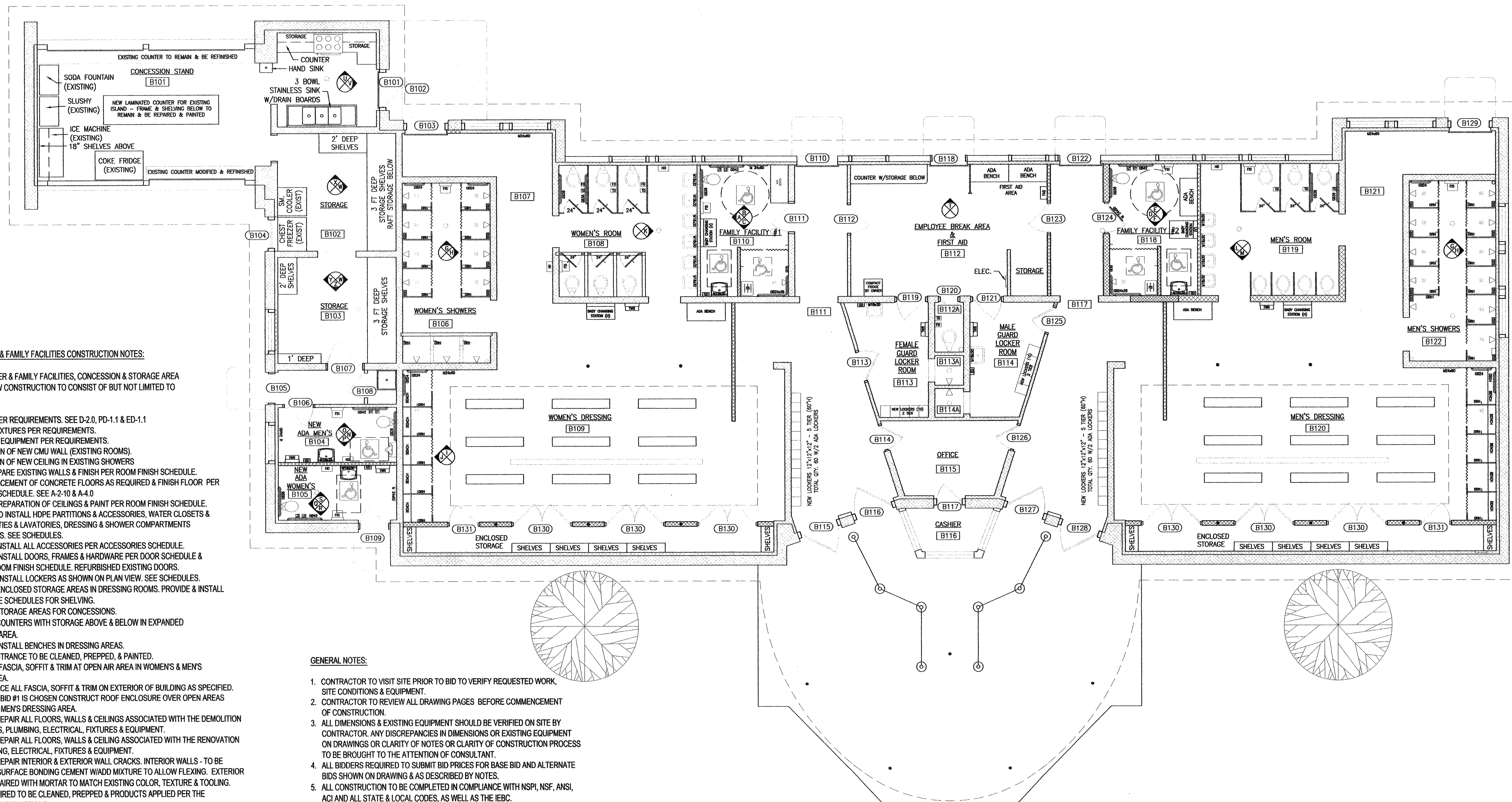

BATHHOUSE RENOVATION PLAN
SCALE: 3/16"=1'-0"

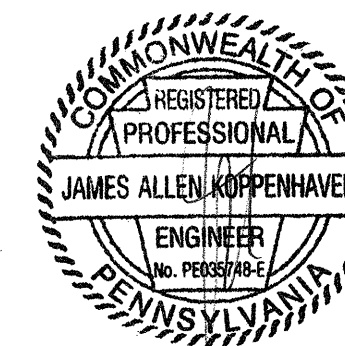

J.S. MACK FOUNDATION
BATHHOUSE RENOVATION
WHITE TOWNSHIP
INDIANA, PENNSYLVANIA 15701

Aquatic Facility Design, Inc.

183 Moore Street
Millersburg, Pennsylvania 17061
1-800-680-SWIM Fax 1-717-692-0950

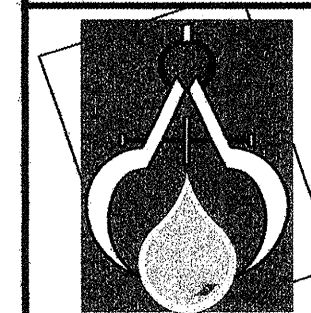

DRAWING TITLE:
BATHHOUSE RENOVATION PLAN
SCALE: AS NOTED
DATE: OCTOBER 18, 2011
DRAWN BY: BA
CHECKED BY: STAFF

DRAWING:

A-2.0